

SURVEY PLAN

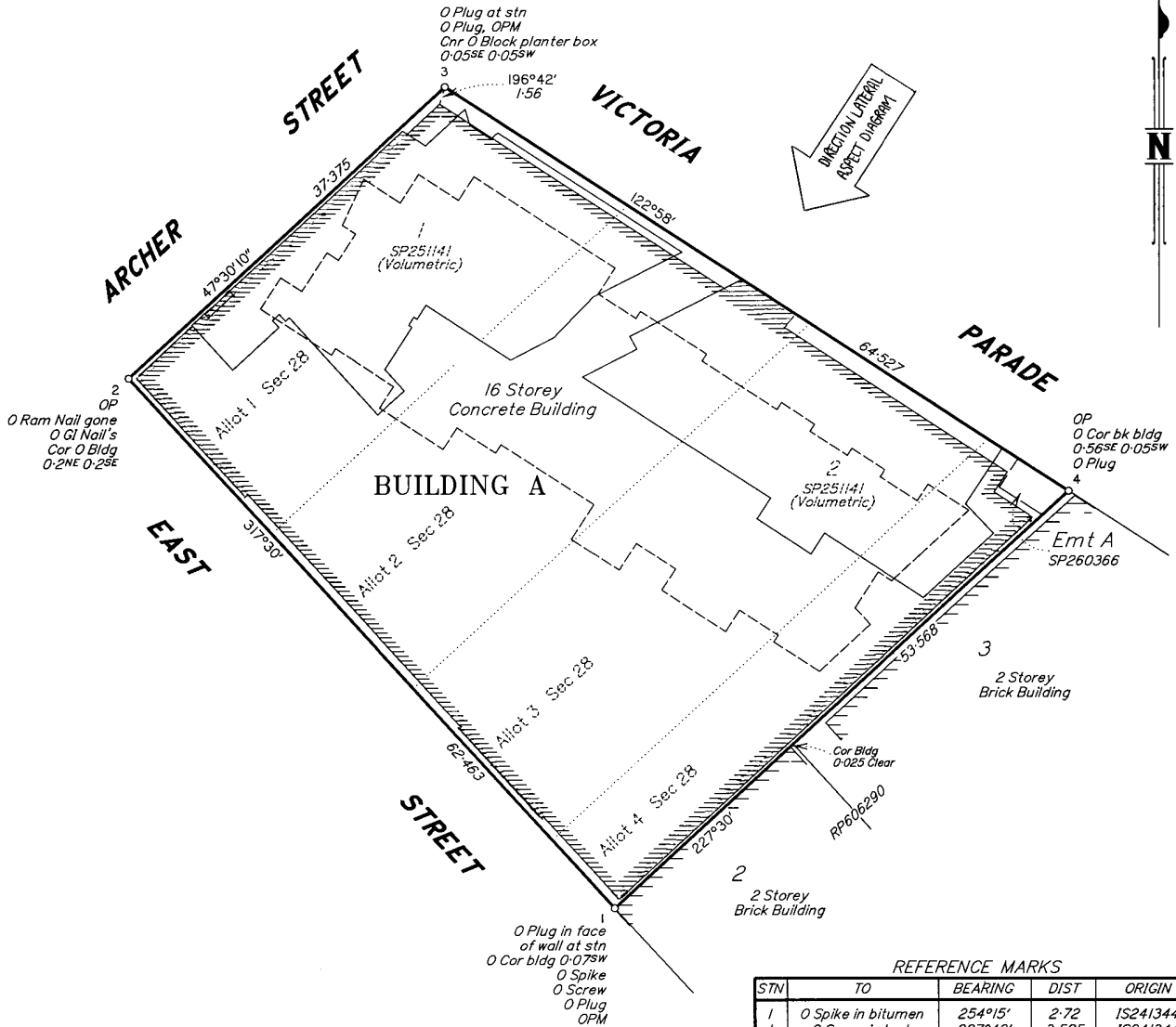

Area of Base Parcel  
2840 m<sup>2</sup>

REFERENCE MARKS

| STN | TO                       | BEARING    | DIST  | ORIGIN   |
|-----|--------------------------|------------|-------|----------|
| 1   | O Spike in bitumen       | 254°15'    | 2.72  | IS241344 |
| 1   | O Screw in kerb          | 227°42'    | 3.585 | IS241344 |
| 1   | O Plug in kerb           | 228°23'30" | 26.25 | IS241344 |
| 2   | O Ram Nail gone          | 297°50'    | 1.985 | IS241344 |
| 2   | O GI Nail in bitumen     | 227°36'30" | 29.35 | IS241344 |
| 2   | O GI Nail in bitumen     | 227°33'    | 30.11 | IS241344 |
| 3   | O Plug in traffic island | 315°50'30" | 35.69 | IS241344 |
| 4   | O Plug in path           | 47°05'30"  | 17.46 | IS241344 |

PERMANENT MARKS

| PM    | BEARING | DIST   | NO     | ORIGIN   |
|-------|---------|--------|--------|----------|
| 1-OPM | 121°04' | 174.72 | 94727  | SP176888 |
| 3-OPM | 315°41' | 91.87  | 175038 | SP215973 |

For encroachments see sheets 18-20.

Amendments by Capricorn Survey Group (CG) Pty Ltd  
ACN 154 830 565  
Director *[Signature]* Date 19-11-14.

Capricorn Survey Group (CG) Pty Ltd (ACN 154 830 565) hereby certify that the land comprised in this plan was surveyed by the corporation, by Max William KIRBY, Surveying Associate, for whose work the corporation accepts responsibility, under the supervision of Richard Jon Knox FORD, Cadastral Surveyor and that the plan is accurate, that the said survey was performed in accordance with the Survey and Mapping Infrastructure Act 2003 and Surveyors Act 2003 and associated Regulations and Standards and that the said survey was completed on 22-10-2014.

*[Signature]* Director / Cadastral Surveyor

24-10-14 Date

Scale 1:400 - Lengths are in Metres.

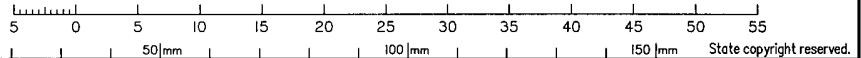

|  |                    |                  |
|--|--------------------|------------------|
| Plan of <b>Lots 101-114, 201-214, 301-314, 401-414, 501-514, 601-614, 701-714, 801-808, 901-908, 1001-1008, 1101-1108, 1201-1204 &amp; 1301-1304 and Common Property</b> |                    | Scale: 1:400     |
| Cancelling Lot 100 on SP 251141  |                    | Format: BUILDING |
| LOCAL GOVERNMENT: Rockhampton R.C. LOCALITY: Rockhampton City  | Survey Records: No | <p>SP251140</p>  |
| Meridian: SP260366   |                    |                  |

Drafted: CADastre Solutions

716141402

\$12244.60  
17/11/2014 09:35

RN 400 NT

WARNING : Folded or Mutilated Plans will not be accepted.  
Plans may be rolled.  
Information may not be placed in the outer margins.

5. Lodged by

Swanwick Murray Roche  
PO Box 111  
Rockhampton 4700  
enquiries@sunlaw.com.au

111

(Include address, phone number, reference, and Lodger Code)

1. Certificate of Registered Owners or Lessees.

I/We WER PTY LTD A.C.N. 104 725 671  
TRUSTEE  
UNDER INSTRUMENT 713002435

(Names in full)

\*as Registered Owners of this land agree to this plan and dedicate the Public Use Land as shown hereon in accordance with Section 50 of the Land Title Act 1994.

\*as Lessees of this land agree to this plan.

*Richard* (D. R. Ford)  
Signature of \*Registered Owners \*Lessees

| 6. Existing     |                     | Created   |      |                     |
|-----------------|---------------------|---|------|---------------------|
| Title Reference | Description         | New Lots  | Road | Secondary Interests |
|                 | Lot 100 on SP251141 | 101-114, 201-214, 301-314, 401-414, 501-514, 601-614, 701-714, 801-808, 901-908, 1001-1008, 1101-1108, 1201-1204, 1301-1304 & Common Property | -    | -                   |

MORTGAGE ALLOCATIONS

| Mortgage  | Lots Fully Encumbered   | Lots Partially Encumbered |
|-----------|---|---------------------------|
| 715229685 | 101-114, 201-214, 301-314, 401-414, 501-514, 601-614, 701-714, 801-808, 901-908, 1001-1008, 1101-1108, 1201-1204, 1301-1304 |                           |

ENCUMBRANCE EASEMENT ALLOCATIONS

| Easement                         | Lots to be Encumbered |
|----------------------------------|-----------------------|
| 715510276<br>(Emt A on SP260366) | Common Property       |

All lots defined in this plan are wholly contained within the base parcel. The Encroachments noted on this plan are accommodated by the provisions of the BMS (volumetric lots)

BMS ALLOCATION

| BMS | Lots to be Encumbered  | Lots to be Benefitted  |
|-----|--|--|
|     | 101-114, 201-214, 301-314, 401-414, 501-514, 601-614, 701-714, 801-808, 901-908, 1001-1008, 1101-1108, 1201-1204, 1301-1304, Common Property | 101-114, 201-214, 301-314, 401-414, 501-514, 601-614, 701-714, 801-808, 901-908, 1001-1008, 1101-1108, 1201-1204, 1301-1304, Common Property |

Encroachments onto road exist for public benefit  
Encroachment notice over roads issued by SP251141 on 19-11-14.  
\* Rule out whichever is inapplicable

2. Planning Body Approval.

\* ROCKHAMPTON REGIONAL COUNCIL  
hereby approves this plan in accordance with the:  
% SUSTAINABLE PLANNING ACT 2009

| COMMON PROPERTY  | ALLOTS 1, 2, 3 & 4 Sec 28       | 109, 110, 209, 210, 309, 310, 409, 410, 509, 510, 609, 610, 709, 710, 805, 905, 1005, 1105, 1203, 1303           | Allot 2 Sec 28 & Allot 3 Sec 28 |
|--|---------------------------------|--|---------------------------------|
| 103, 104, 105, 203, 204, 205, 303, 304, 305, 403, 404, 405, 503, 504, 505, 603, 604, 605, 703, 704, 705, 802, 902, 1002, 1102  | Allot 1 Sec 28                  | 111, 114, 211, 214, 311, 314, 411, 414, 511, 514, 611, 614, 711, 714, 806, 808, 906, 908, 1006, 1008, 1106, 1108 | Allot 3 Sec 28                  |
| 101, 102, 106, 107, 201, 202, 206, 207, 301, 302, 306, 307, 401, 402, 406, 407, 501, 502, 506, 507, 601, 602, 606, 607, 701, 702, 706, 707, 801, 803, 804, 901, 903, 904, 1001, 1003, 1004, 1101, 1103, 1104, 1201, 1202, 1301, 1302 | Allot 1 Sec 28 & Allot 2 Sec 28 | 112, 113, 212, 213, 312, 313, 412, 413, 512, 513, 612, 613, 712, 713, 807, 907, 1007, 1107, 1204, 1304           | Allot 3 Sec 28 & Allot 4 Sec 28 |
| 108, 208, 308, 408, 508, 608, 708  | Allot 2 Sec 28                  |  |                                 |
| Lots   | Orig                            | Lots   | Orig                            |

Development Approval Date - 4th June 2012

12. Building Format Plans only.

I certify that:  
\* As far as it is practical to determine, no part of the building shown on this plan encroaches onto adjoining lots or road.  
\* Part of the building shown on this plan encroaches onto adjoining \* lots and road and road.  
*Richard*  
Cadastral Surveyor/Director \* Date 22-10-14  
\*delete words not required

Dated this 12TH day of NOVEMBER 2014

*Benfield*

# Philip Benfield  
Administrator-Operational Works  
(Delegated Person)

\* Insert the name of the Planning Body. % Insert applicable approving legislation.  
# Insert designation of signatory or delegation

3. Plans with Community Management Statement :

CMS Number : 46677  
Name : Empire Apartments Rockhampton

4. References :

Dept File : D/306-2011  
Local Govt :  
Surveyor : R5530

7. Orig Grant Allocation :

8. Map Reference :  
9051-34333

9. Parish :  
ROCKHAMPTON

10. County :  
LIVINGSTONE

11. Passed & Endorsed :

By : Richard Jon Knox Ford  
Date : 22-10-14  
Signed : *Richard*  
Designation : Cadastral Surveyor

13. Lodgement Fees :

Survey Deposit \$ .....  
Lodgement \$ .....  
..... New Titles \$ .....  
Photocopy \$ .....  
Postage \$ .....  
TOTAL \$ .....

14. Insert Plan Number  
SP251140

LEVEL A  
1:250

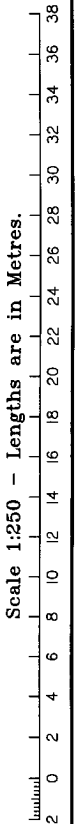
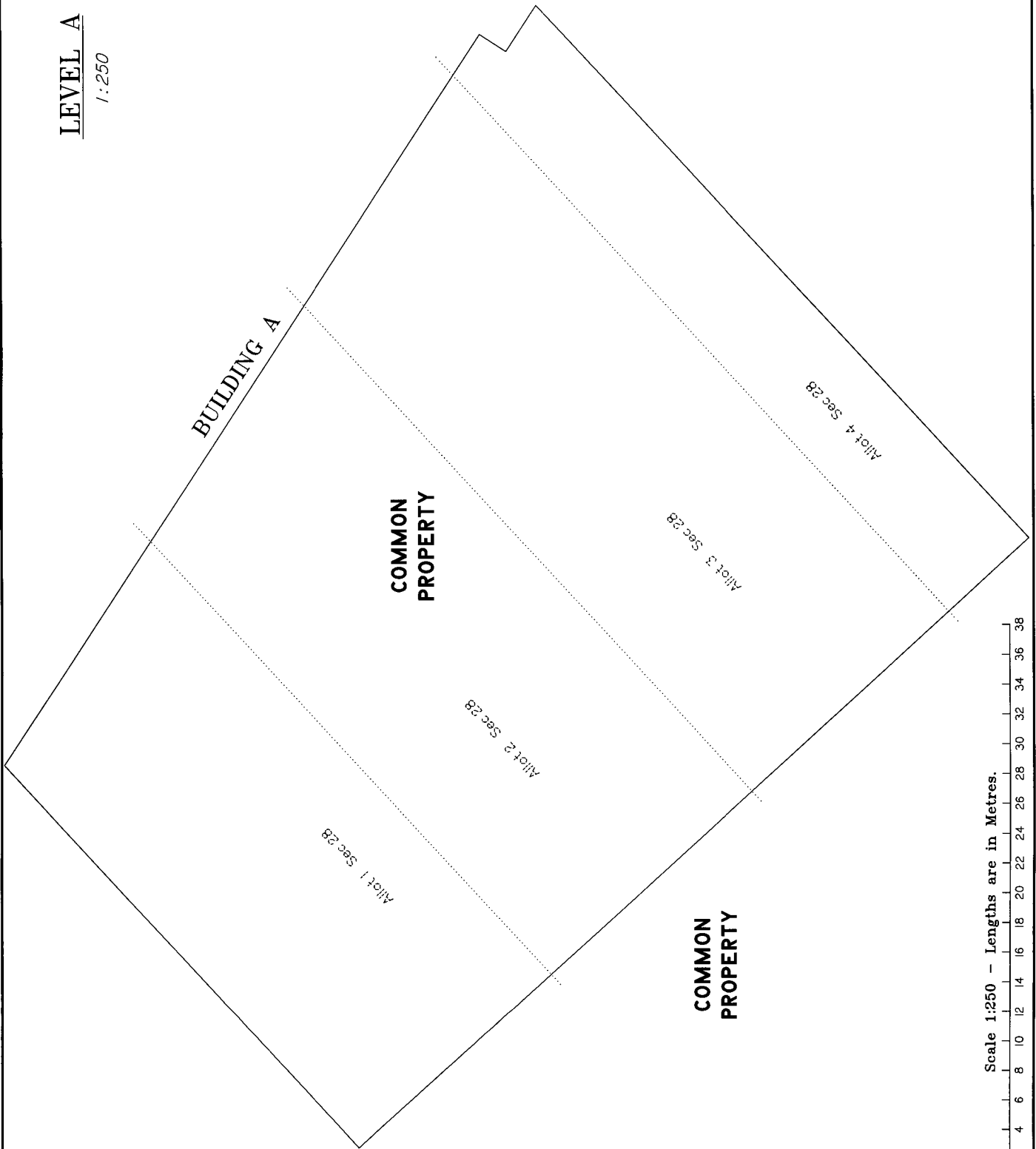

State copyright reserved.

Insert Plan Number **SP251140**

**LEVEL B**  
1:250

**BUILDING A**

**COMMON  
PROPERTY**

**COMMON  
PROPERTY**

Allot 1 Sec 28

Allot 2 Sec 28

Allot 3 Sec 28

Allot 4 Sec 28

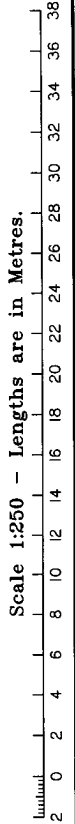

State copyright reserved.

Insert Plan Number **SP251140**

LEVEL C  
1:250

VICTORIA PARADE

2  
SP251141  
(Volumetric)

Allot 4 Sec 28

COMMON  
PROPERTY

Allot 3 Sec 28

Allot 2 Sec 28

BUILDING A

COMMON  
PROPERTY

1  
SP251141  
(Volumetric)

Allot 1 Sec 28

Level Below

Level Below

Level Below

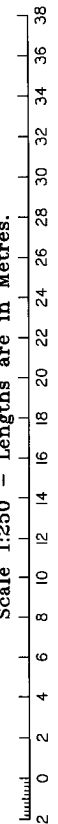

Scale 1:250 - Lengths are in Metres.



State copyright reserved.

Insert Plan Number SP251140



**LEVEL D**  
1:250



Scale 1:250 - Lengths are in Metres.

**LEVEL E**

1:250

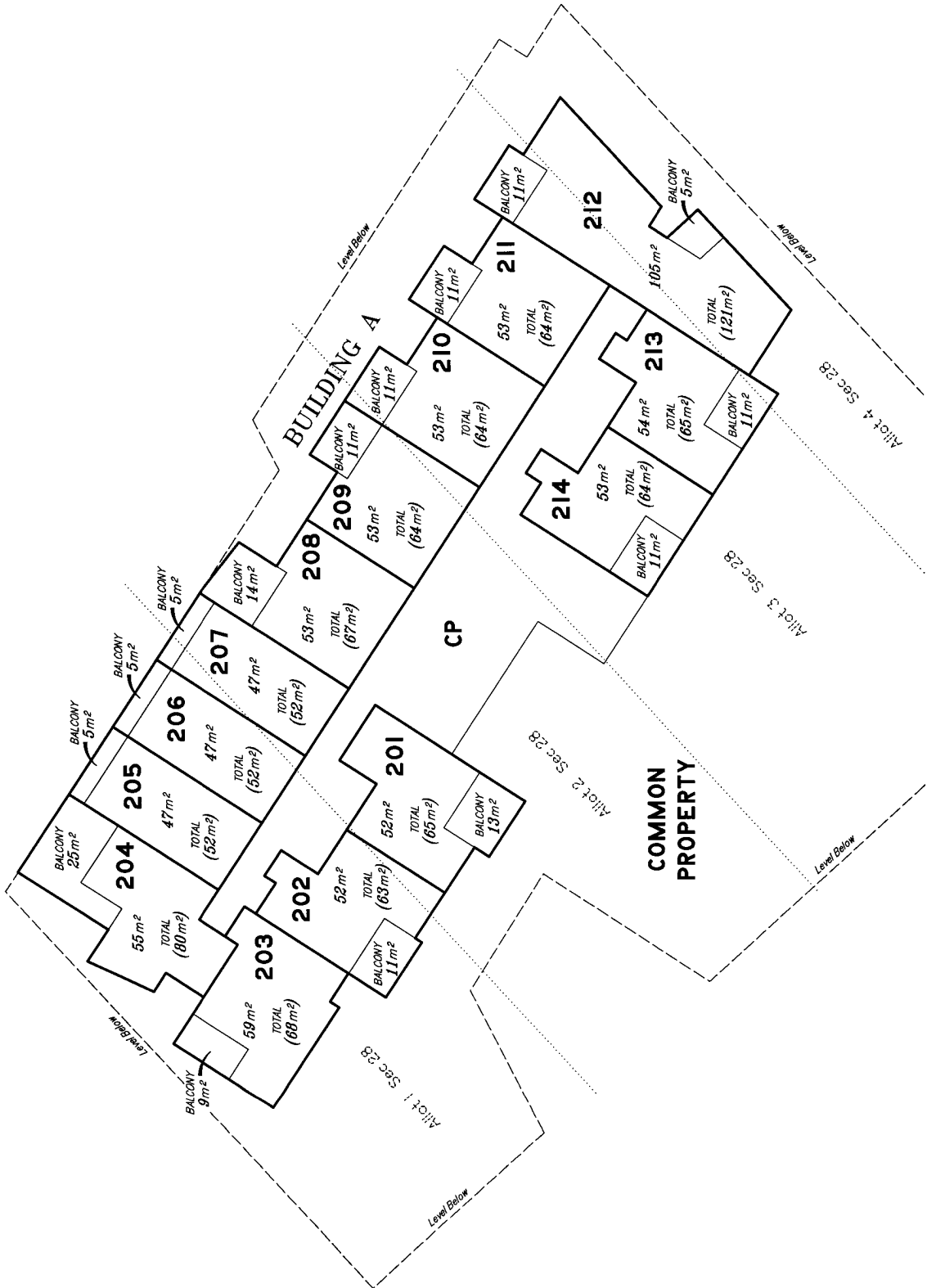

Scale 1:250 - Lengths are in Metres.



State copyright reserved.

Insert Plan Number **SP251140**

**LEVEL F**  
1:250

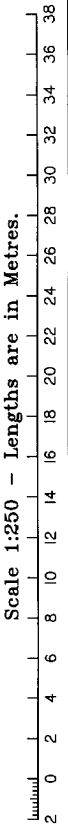
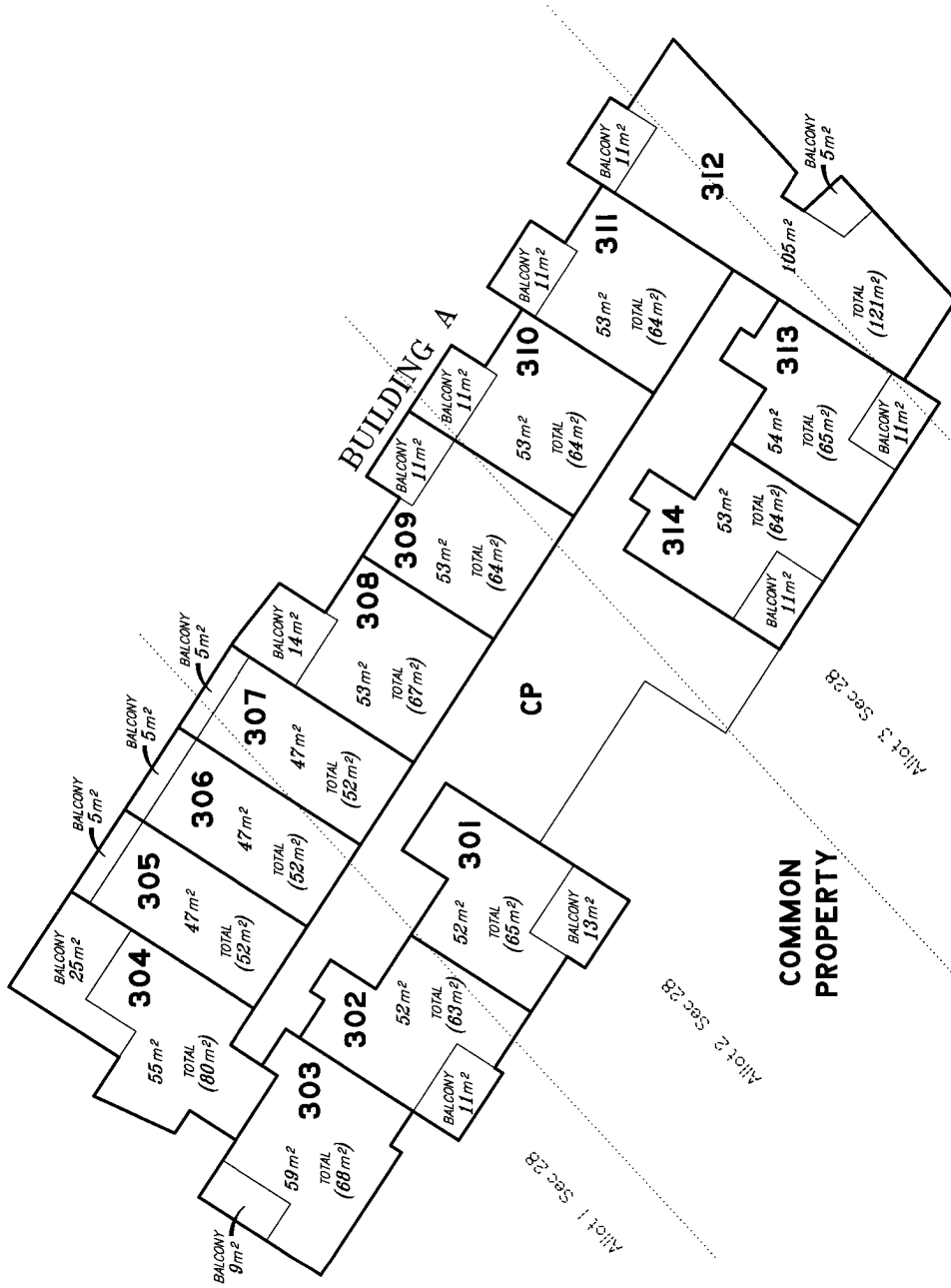



**LEVEL G**  
1:250

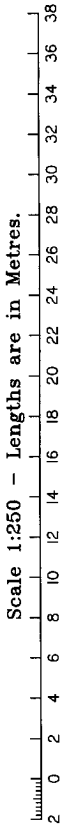
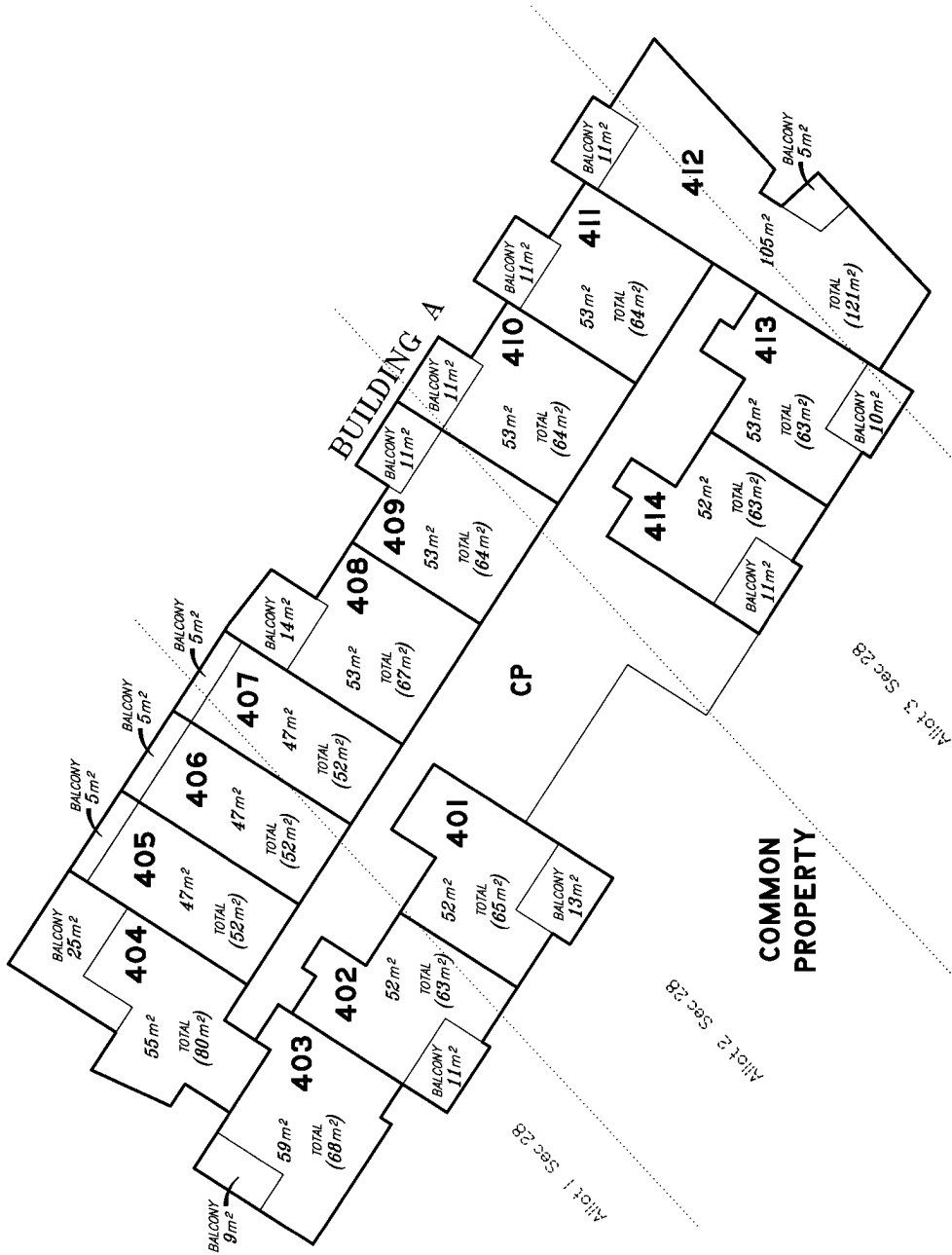

**LEVEL H**  
1:250

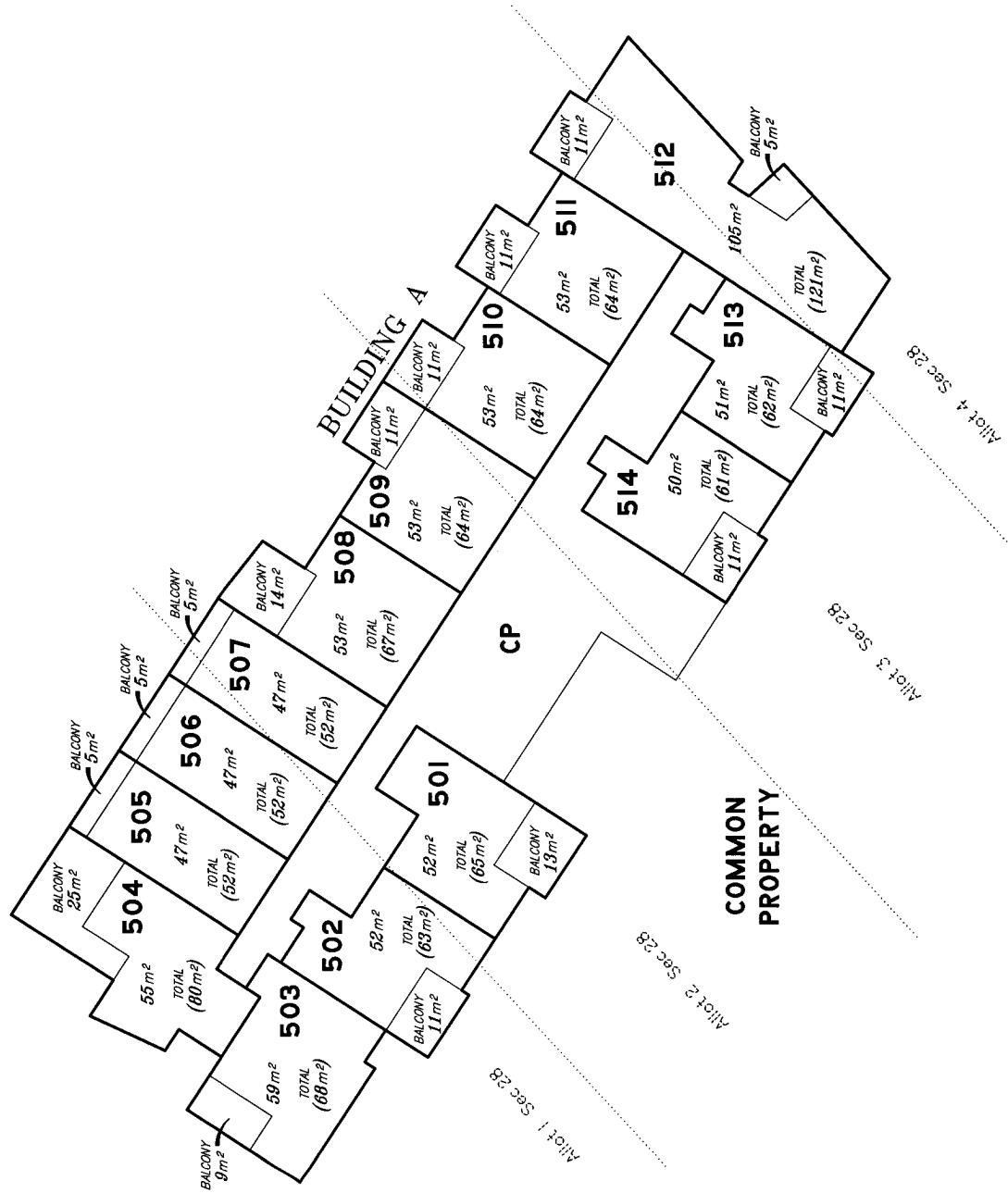

Scale 1:250 - Lengths are in Metres.

0 2 4 6 8 10 12 14 16 18 20 22 24 26 28 30 32 34 36 38

0 50mm 100mm 150mm

Insert Plan Number SP251140

State copyright reserved.

**LEVEL I**  
1:250

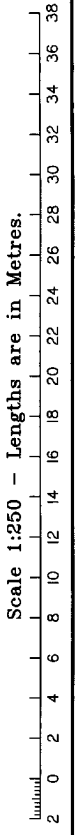
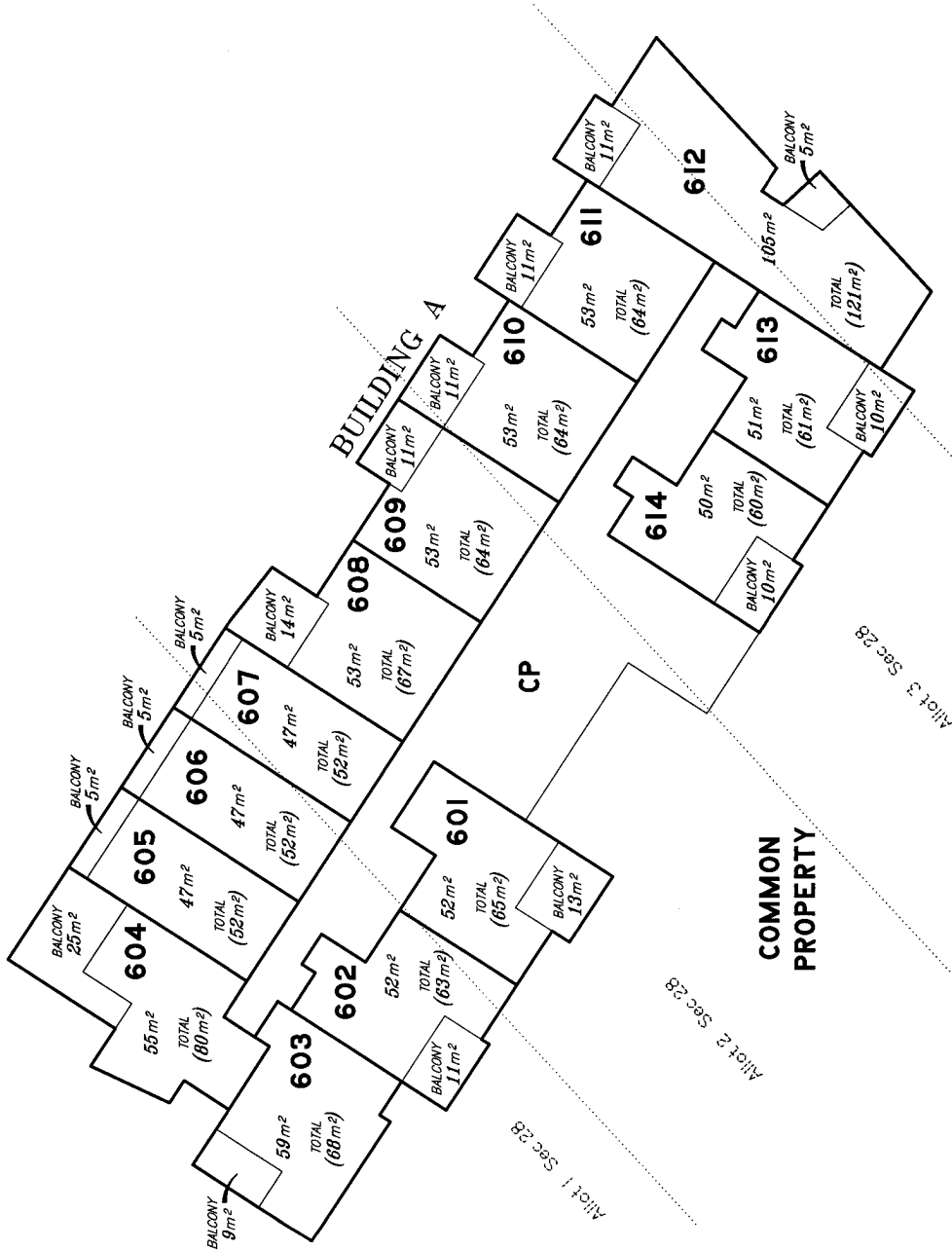

0 50mm 100mm 150mm

**LEVEL J**  
1:250

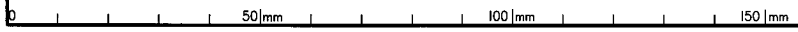
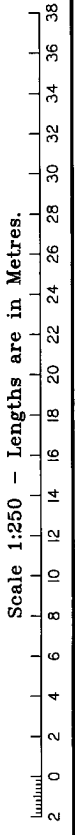
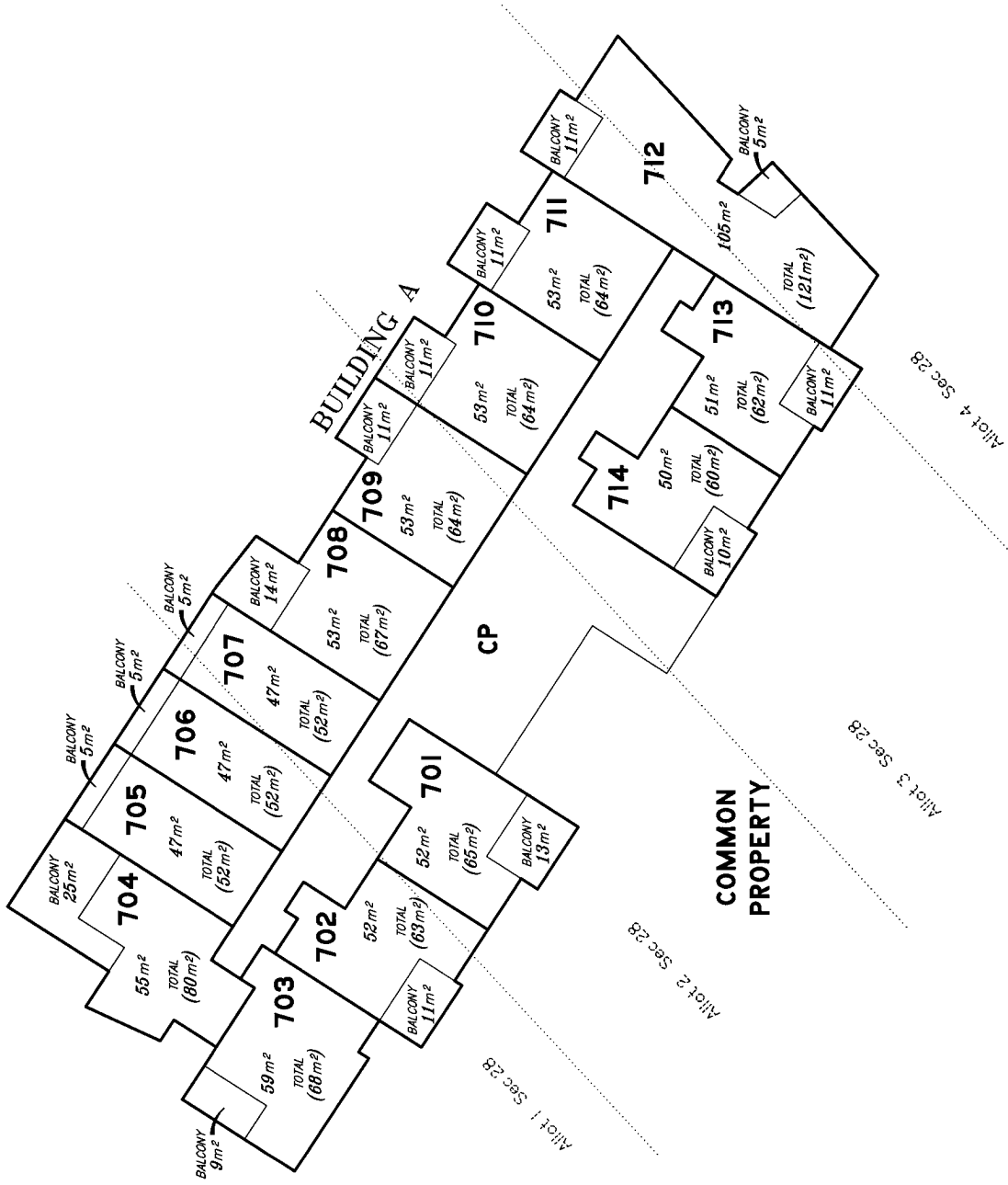

State copyright reserved.

Insert Plan Number **SP251140**

**LEVEL K**

1:250

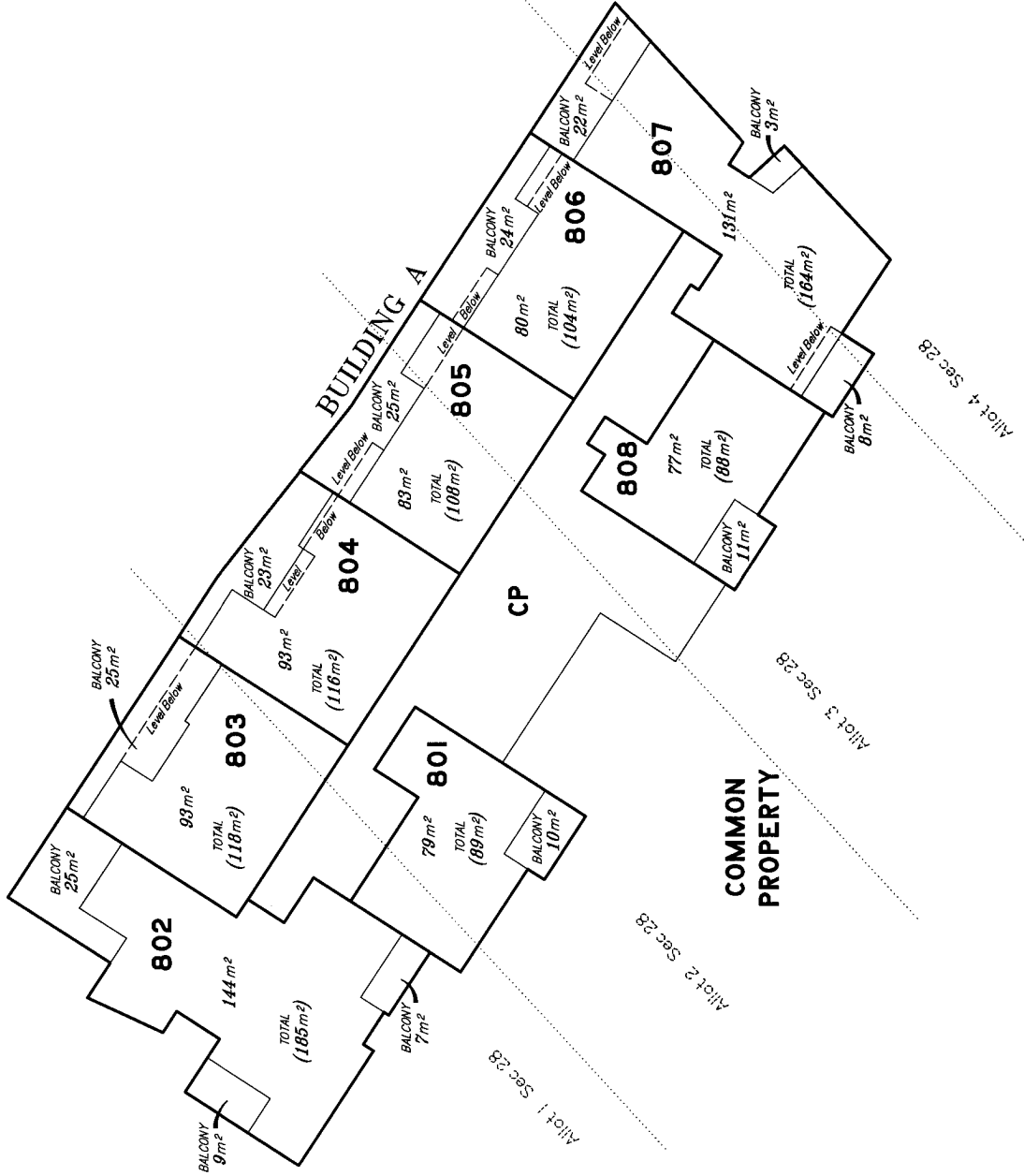

Scale 1:250 - Lengths are in Metres.

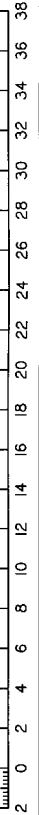

50mm 100mm 150mm

State copyright reserved.

Insert Plan Number **SP251140**

**LEVEL 1**  
1:250

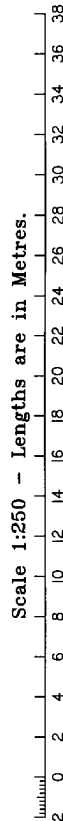
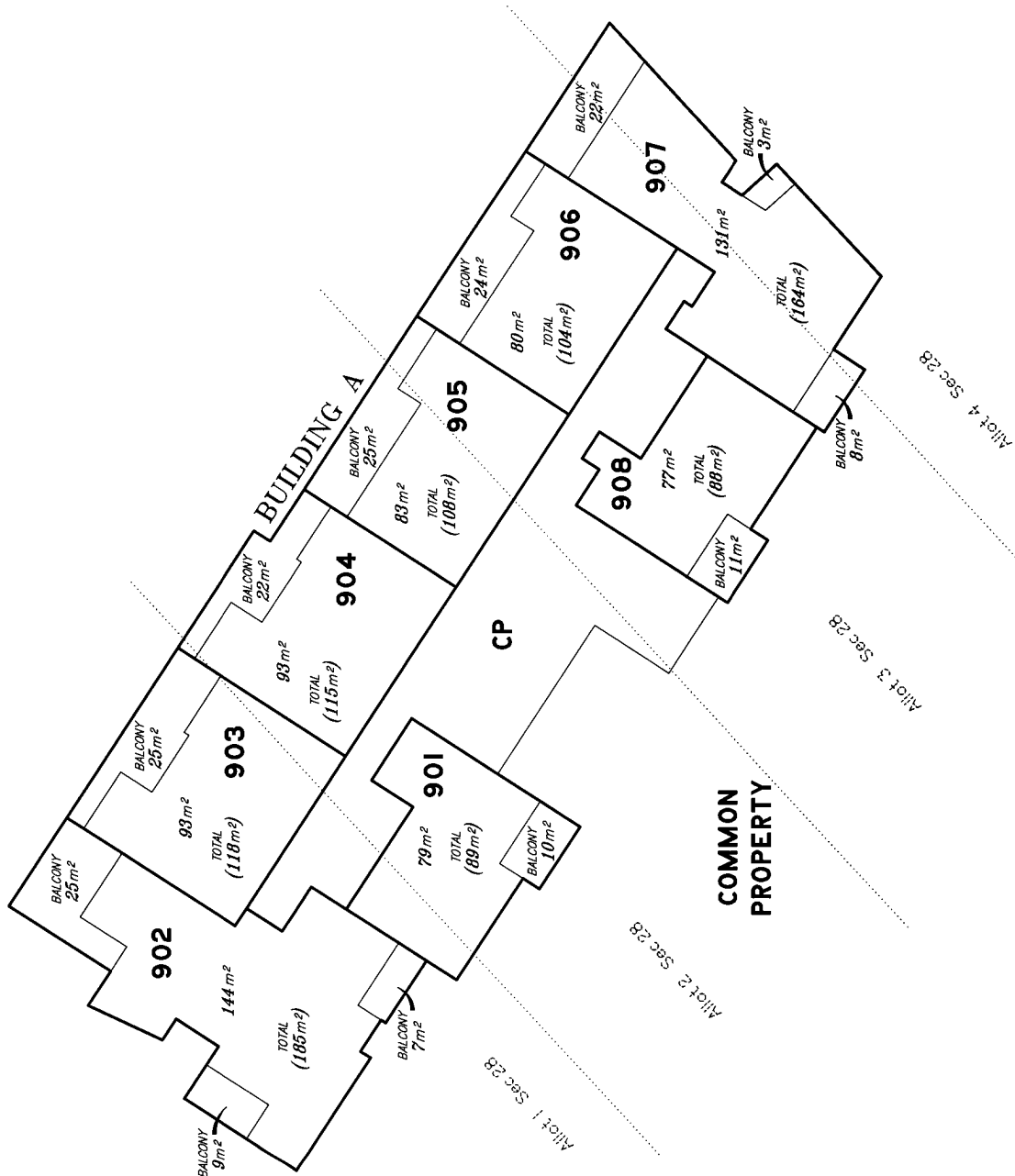

**LEVEL M**  
1:250

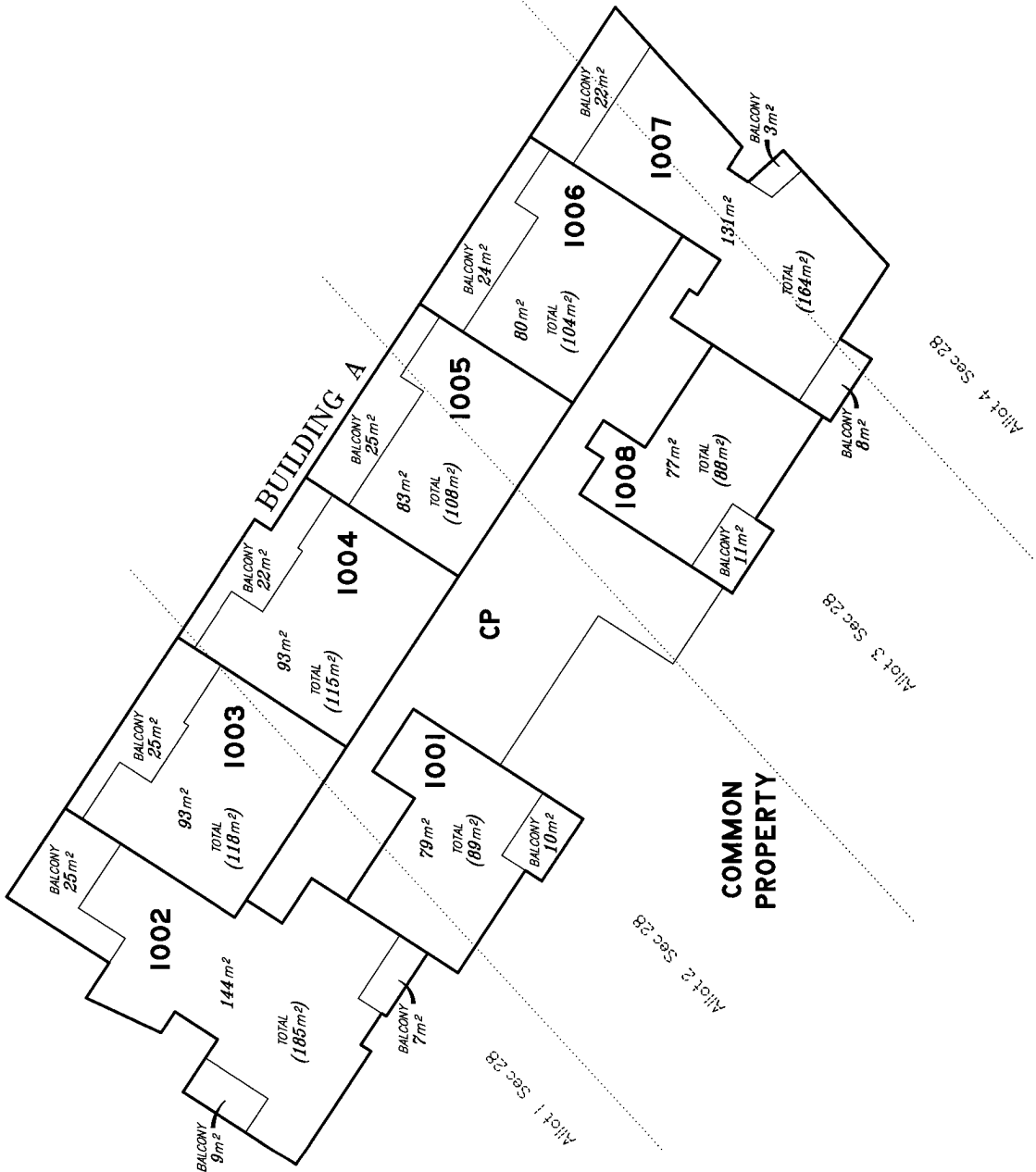

Scale 1:250 - Lengths are in Metres.

0 2 4 6 8 10 12 14 16 18 20 22 24 26 28 30 32 34 36 38



0 50mm 100mm 150mm

State copyright reserved.

Insert Plan Number **SP251140**

**LEVEL N**  
1:250

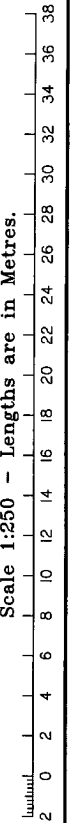
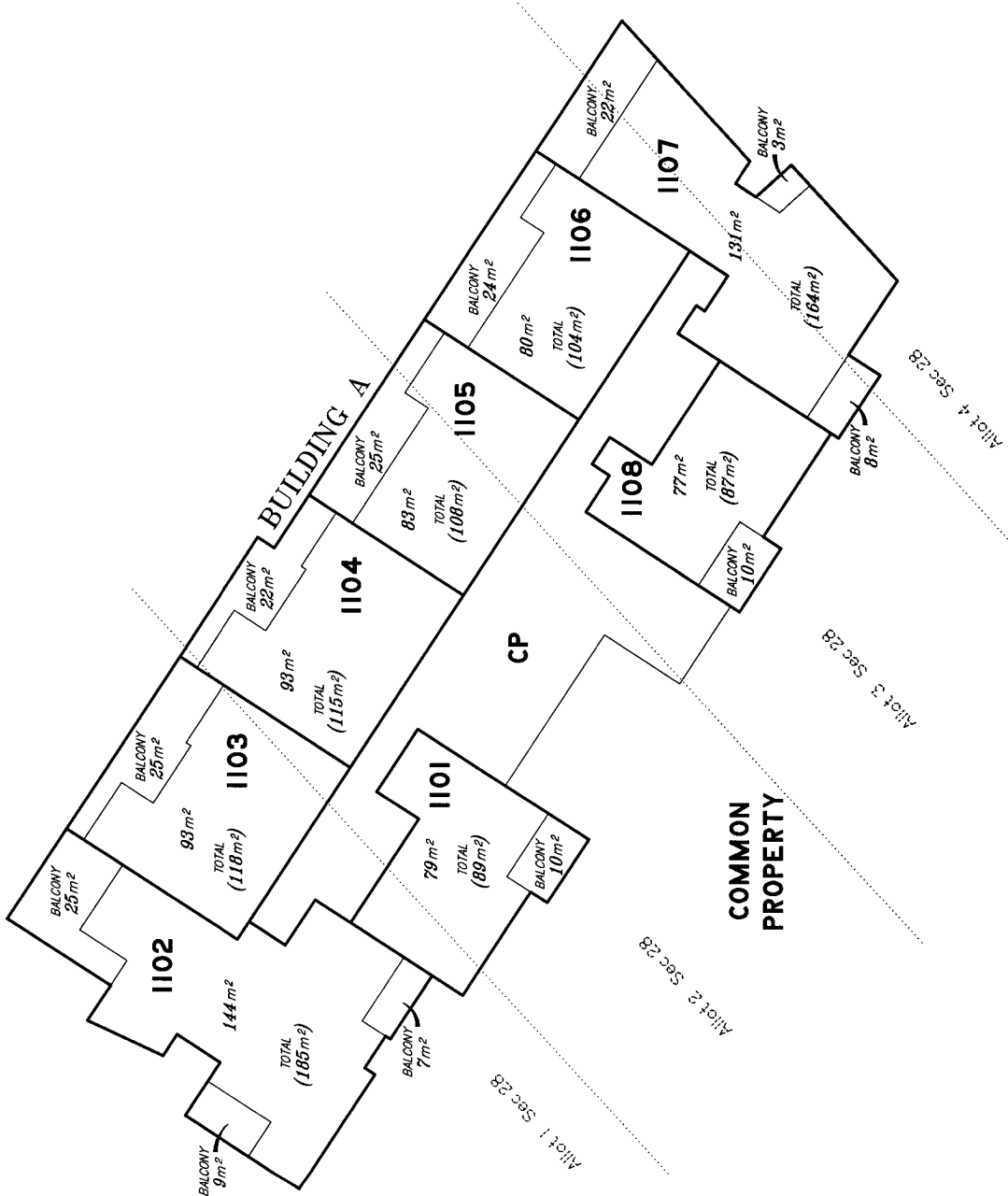

0 50mm 100mm 150mm

Insert Plan Number SP251140

State copyright reserved.



LEVEL 0  
1:250

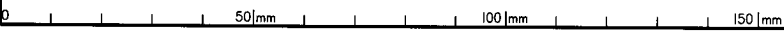
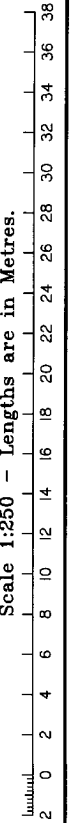
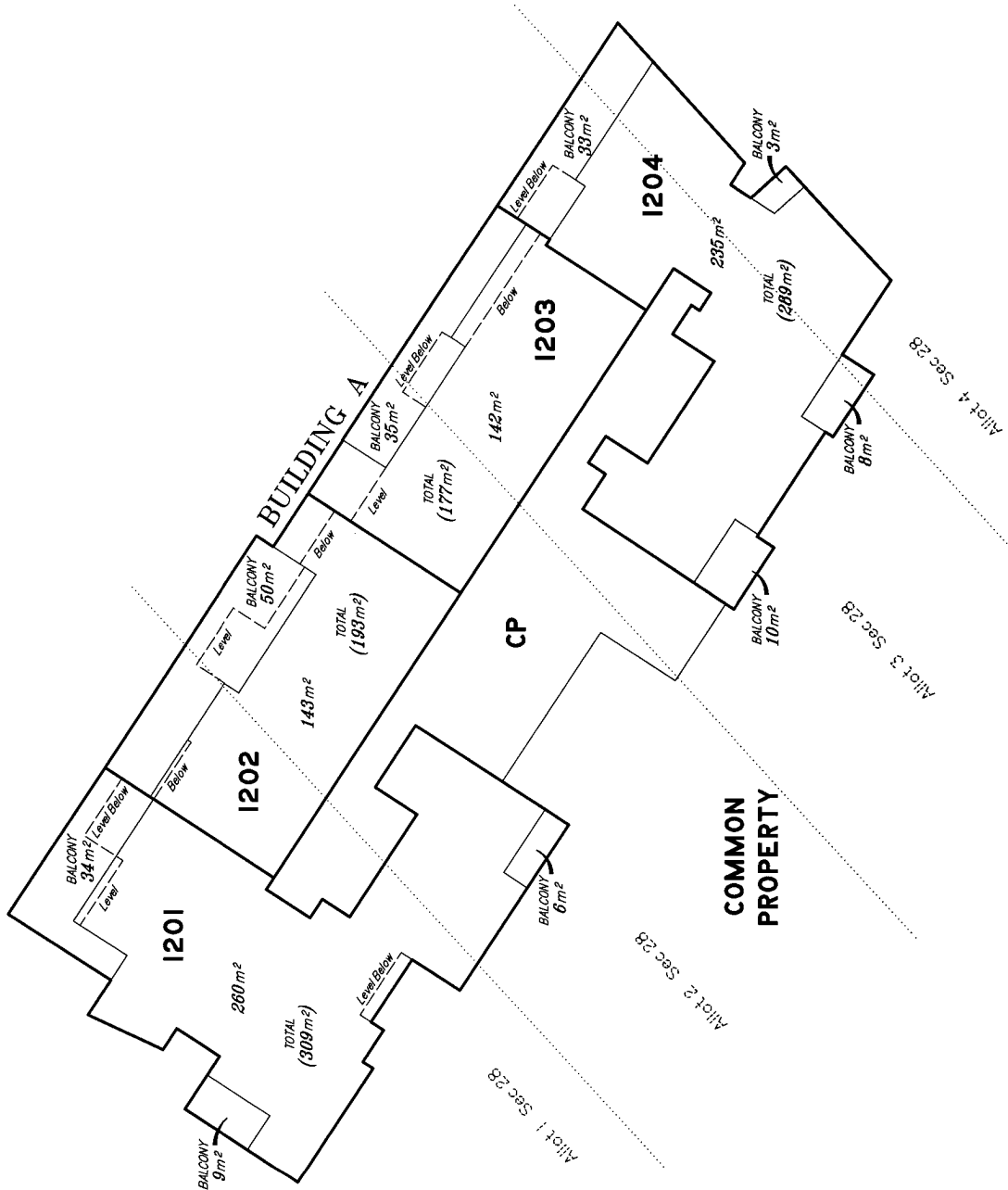

State copyright reserved.

Insert Plan Number SP251140

**LEVEL P**

1:250

**COMMON  
PROPERTY**

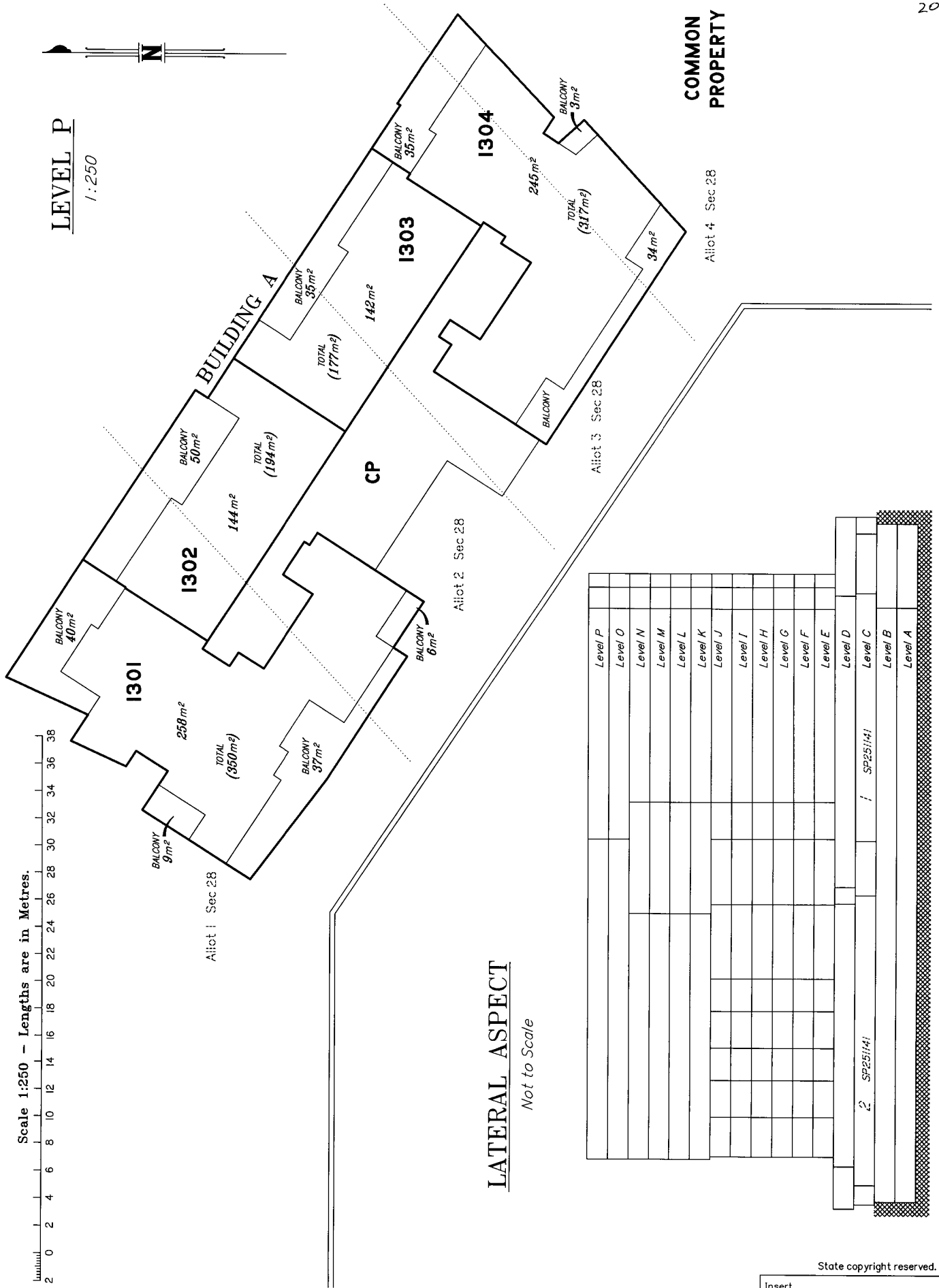

**LATERAL ASPECT**

Not to Scale

|         |  |
|---------|--|
| Level P |  |
| Level O |  |
| Level N |  |
| Level M |  |
| Level L |  |
| Level K |  |
| Level J |  |
| Level I |  |
| Level H |  |
| Level G |  |
| Level F |  |
| Level E |  |
| Level D |  |
| Level C |  |
| Level B |  |
| Level A |  |

  

|   |          |
|---|----------|
| 2 | SP251141 |
| 1 | SP251141 |

State copyright reserved.

Insert Plan Number **SP251140**

Scale 1:250 - Lengths are in Metres.

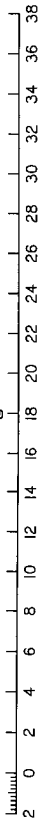

50mm 100mm 150mm

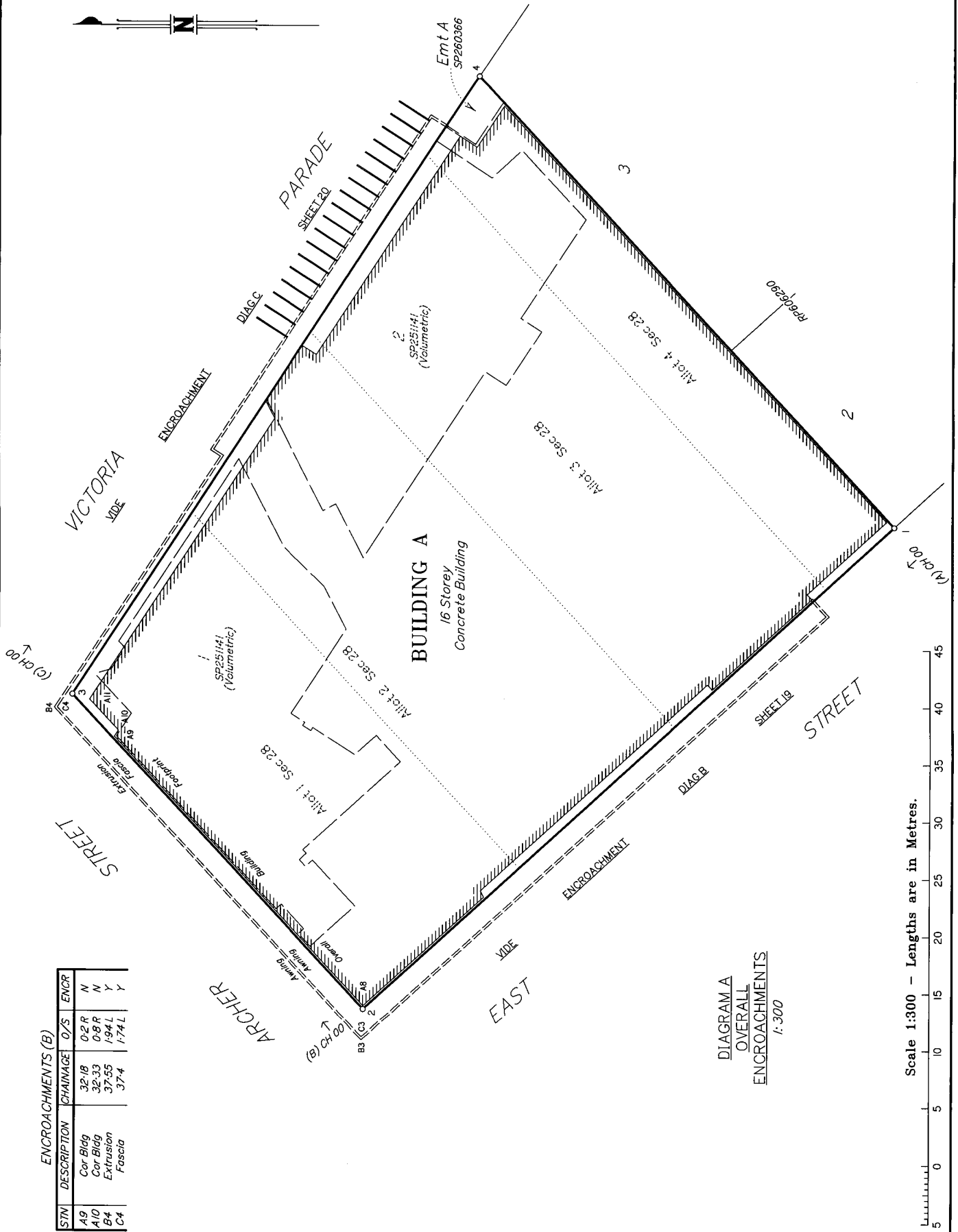

**ENCROACHMENTS (B)**

| STN | DESCRIPTION | CHAINAGE | O/S   | ENCR |
|-----|-------------|----------|-------|------|
| A9  | Car Bldg    | 32/18    | 0/2R  | N    |
| A10 | Car Bldg    | 32/33    | 0/8R  | N    |
| B4  | Extrusion   | 37/55    | 1/94L | Y    |
| C4  | Fascia      | 37/4     | 1/74L | Y    |

DIAGRAM A  
OVERALL  
ENCROACHMENTS  
1:300

Scale 1:300 - Lengths are in Metres.



DIAGRAM B  
ENCROACHMENT  
1:200

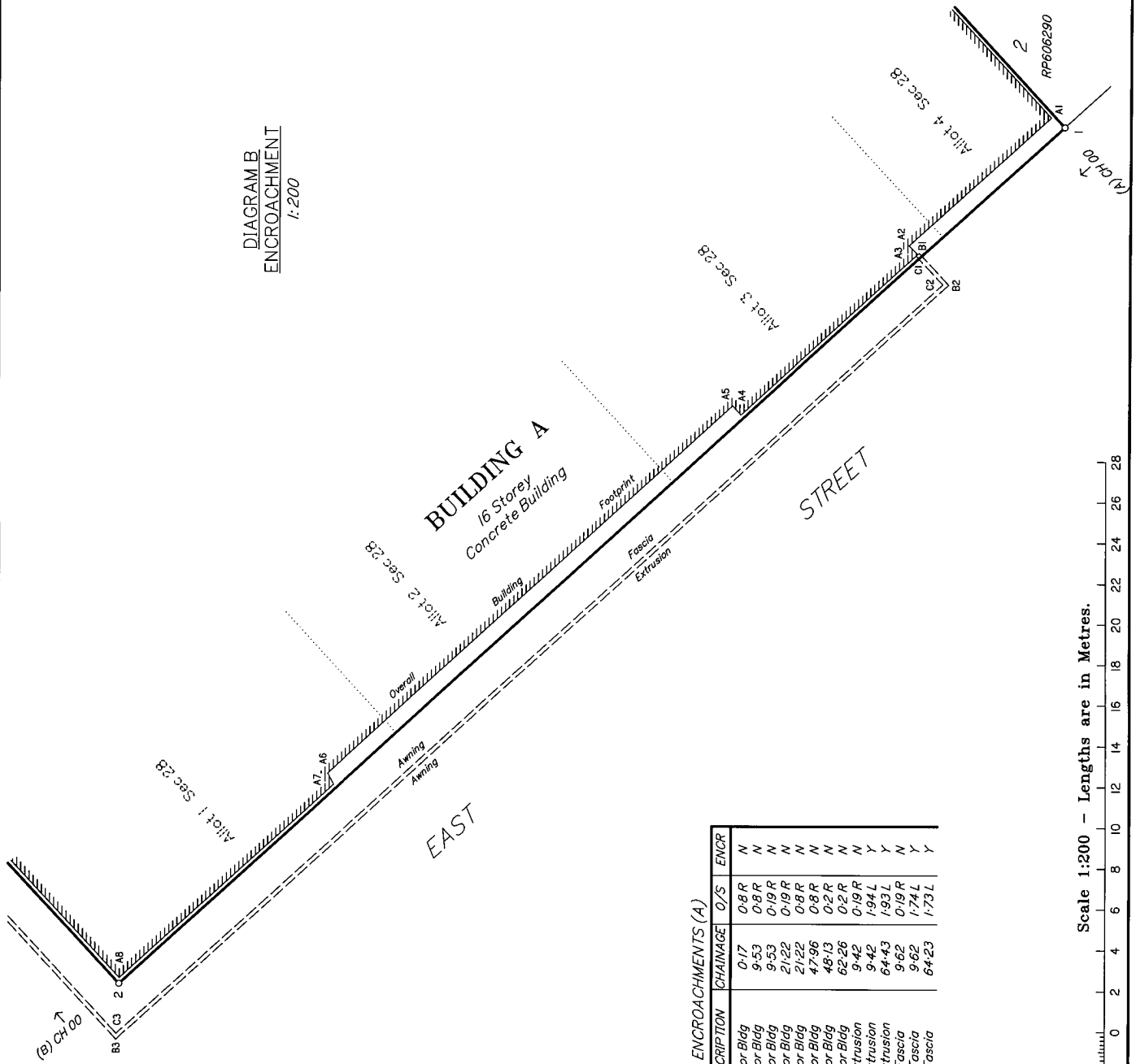

ENCROACHMENTS (A)

| STN | DESCRIPTION | CHAINAGE | O/S    | ENCR |
|-----|-------------|----------|--------|------|
| A1  | Cor-Bldg    | 0-17     | 0-8 R  | N    |
| A2  | Cor-Bldg    | 9-53     | 0-8 R  | N    |
| A3  | Cor-Bldg    | 9-53     | 0-19 R | N    |
| A4  | Cor-Bldg    | 21-22    | 0-19 R | N    |
| A5  | Cor-Bldg    | 21-22    | 0-8 R  | N    |
| A6  | Cor-Bldg    | 47-96    | 0-8 R  | N    |
| A7  | Cor-Bldg    | 48-13    | 0-2 R  | N    |
| A8  | Cor-Bldg    | 62-26    | 0-2 R  | N    |
| B1  | Extrusion   | 9-42     | 1-94 L | Y    |
| B2  | Extrusion   | 9-42     | 1-93 L | Y    |
| B3  | Extrusion   | 64-43    | 0-19 R | Y    |
| C1  | Fascia      | 9-62     | 1-74 L | Y    |
| C2  | Fascia      | 9-62     | 1-73 L | Y    |
| C3  | Fascia      | 64-23    | 1-73 L | Y    |

Scale 1:200 - Lengths are in Metres.

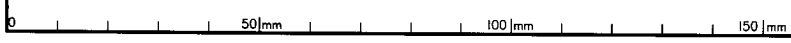
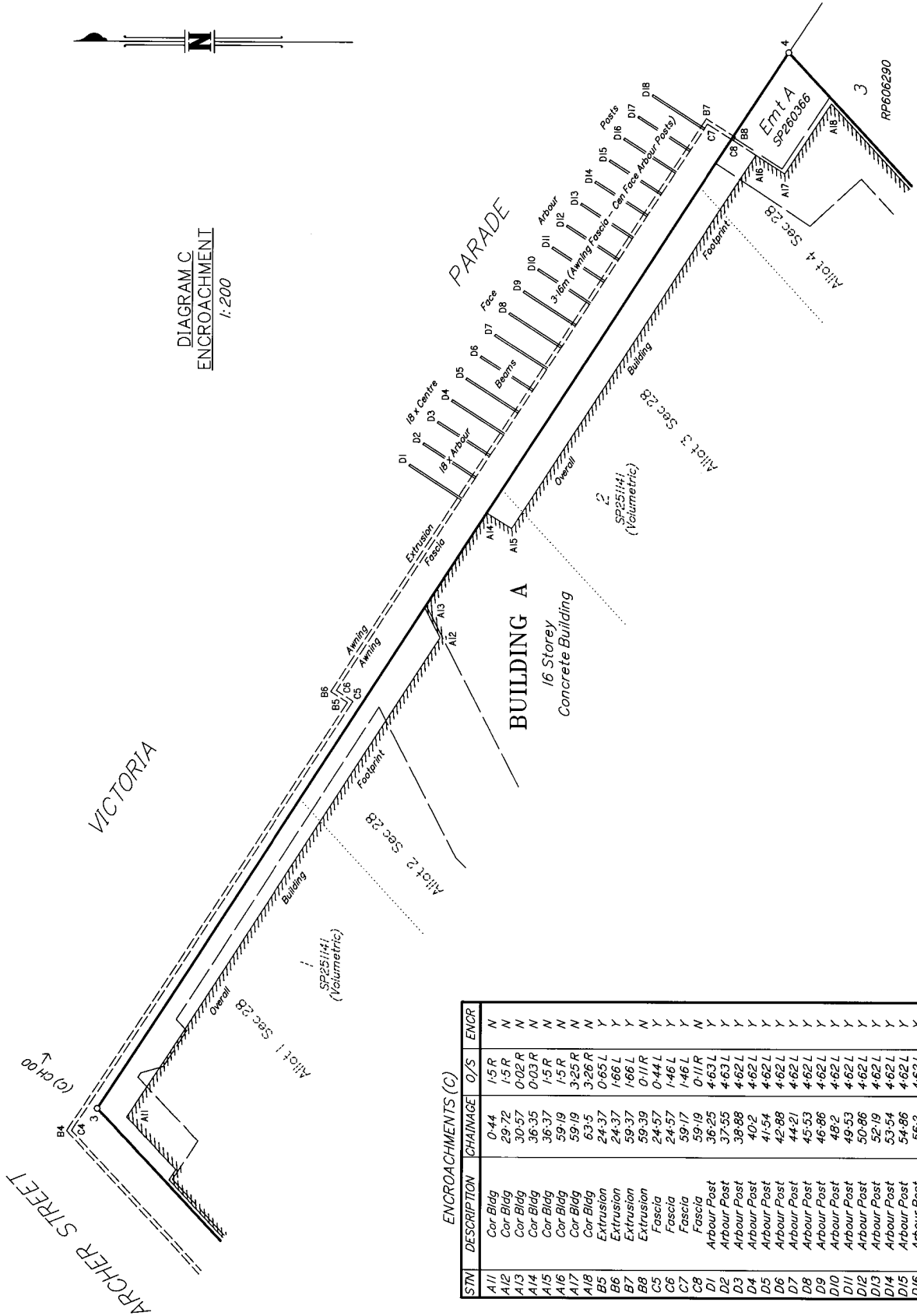



DIAGRAM C  
ENCROACHMENT  
1:200



ENCROACHMENTS (C)

| STN | DESCRIPTION | CHAINAGE | O/S    | ENCR |
|-----|-------------|----------|--------|------|
| A11 | Cor Bldg    | 0-44     | 1-5 R  | N    |
| A12 | Cor Bldg    | 29-72    | 1-5 R  | N    |
| A13 | Cor Bldg    | 30-57    | 0-02 R | N    |
| A14 | Cor Bldg    | 36-35    | 0-03 R | N    |
| A15 | Cor Bldg    | 36-37    | 1-5 R  | N    |
| A16 | Cor Bldg    | 59-19    | 1-5 R  | N    |
| A17 | Cor Bldg    | 59-19    | 3-25 R | N    |
| A18 | Cor Bldg    | 63-5     | 3-26 R | N    |
| B5  | Extrusion   | 24-37    | 0-65 L | N    |
| B6  | Extrusion   | 24-37    | 1-66 L | Y    |
| B7  | Extrusion   | 59-37    | 1-66 L | Y    |
| B8  | Extrusion   | 59-39    | 0-11 R | Y    |
| C5  | Fascia      | 24-57    | 0-44 L | Y    |
| C6  | Fascia      | 24-57    | 1-46 L | Y    |
| C7  | Fascia      | 39-17    | 1-46 L | Y    |
| C8  | Fascia      | 39-19    | 0-11 R | N    |
| D1  | Arbour Post | 36-25    | 4-63 L | Y    |
| D2  | Arbour Post | 37-55    | 4-63 L | Y    |
| D3  | Arbour Post | 39-88    | 4-62 L | Y    |
| D4  | Arbour Post | 40-2     | 4-62 L | Y    |
| D5  | Arbour Post | 41-54    | 4-62 L | Y    |
| D6  | Arbour Post | 42-88    | 4-62 L | Y    |
| D7  | Arbour Post | 44-21    | 4-62 L | Y    |
| D8  | Arbour Post | 45-53    | 4-62 L | Y    |
| D9  | Arbour Post | 46-86    | 4-62 L | Y    |
| D10 | Arbour Post | 48-2     | 4-62 L | Y    |
| D11 | Arbour Post | 49-53    | 4-62 L | Y    |
| D12 | Arbour Post | 50-86    | 4-62 L | Y    |
| D13 | Arbour Post | 52-19    | 4-62 L | Y    |
| D14 | Arbour Post | 53-54    | 4-62 L | Y    |
| D15 | Arbour Post | 54-86    | 4-62 L | Y    |
| D16 | Arbour Post | 56-2     | 4-62 L | Y    |
| D17 | Arbour Post | 57-53    | 4-63 L | Y    |
| D18 | Arbour Post | 58-86    | 4-62 L | Y    |

Scale 1:200 - Lengths are in Metres.